

Touch Panel assembly devices

 **Made in NIPPON!**

8.4 inches, 10.4 inches, 12.1 inches

Flexible customization

- USB wireless LAN adaptor, GPS module
These options are suitable for moving apparatuses such as vehicles and train.
- Interfaces
Interfaces on Small Touch Panel Classemy Devices with digital I/O interfaces are customizable
- Optional frames and panels
Our robust aluminum frame allows the flat panel mounting.

Suitable for embedded devices

The product, which assures wide operating temperature range, zero spindle, small design, and high durability, is suitable as embedded device.

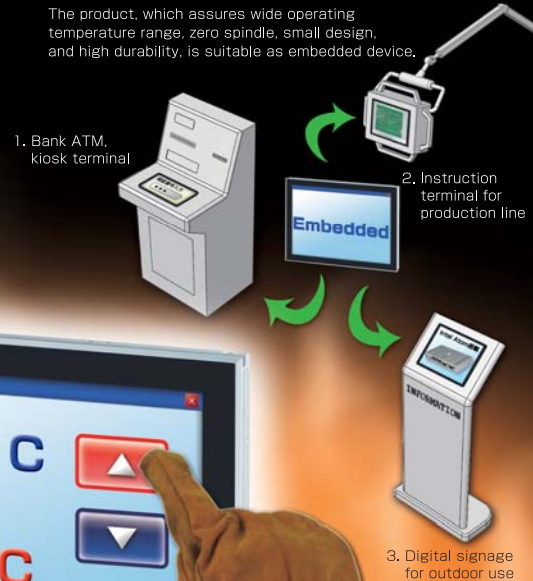

Small Touch Panel Classemy Devices with rich I/O interfaces

- * CFast slot for a boot device
- * Flexible embedding solution as a zero spindle stand-alone controller

<Models>

TPC-B016SA08(S)	8.4 inches	¥148,000-
TPC-B016SA10(S)	10.4 inches	¥158,000-
TPC-B016SA12(S)	12.1 inches	¥168,000-

(Sample price per product when ordering 100 pieces)

Connector side

12.1 inches

10.4 inches

- 20 degree C to +70 degree C

High durability and wide operating temperature range
Controllable even with your gloves on
Robust design for field use

OK

- #### Specifications
- Extended Temperature
 - Intel® Atom™ Processor E680T (1.6 GHz)
 - Liquid crystal display: LED back light
 - Touch panel: glass/glass resistive
 - Audio: line input x 1, line output x 1
 - LAN: 1 Gbps x 1
 - 4 x 4 key matrix (digital input/output)
 - Main memory: 1 GB
 - Boot device: CFast 4 GB
 - Serial communications: CAN x 1, RS-232C x 1, USB2.0 x 6 (2 on the connector side, 4 on the other side)
 - Operating systems: Windows Embedded Standard 2009, Linux

All models include an Intel® Atom™ Processor E680T



NEW

September 15, 2010
Intel Corporation released the Intel® Atom™ Processor E680T, which supports wide temperature range.

Interface Corporation released Touch Panel Classemy Devices that include the Intel® Atom™ Processor E680T at the same time.

For versatile application

- Wide temperature range from -20 °C to +80 °C
- Simple design suitable for embedded system
- Glass/glass Touch Panel Classemy Devices Controllable even with your gloves on

Network boot type Touch Panel Classemy Devices

The OS image of Windows Embedded Standard 2009 is downloaded from the server instead of having a boot device. The feature helps you to build a secure information system.

<Models>

TPC-B016NB08	8.4 inches	¥118,000-
TPC-B016NB10	10.4 inches	¥128,000-
TPC-B016NB12	12.1 inches	¥138,000-

(Sample price per product when ordering 100 pieces)
*An additional initial support fee is required.

8.4 inches

- #### Specifications
- Extended Temperature Intel® Atom™ Processor E680T (1.6 GHz)
 - Liquid crystal display: LED back light
 - Touch panel: glass/glass resistive
 - Audio: line input x 1, line output x 1
 - LAN: 1 Gbps x 1
 - 4 x 4 key matrix (digital input/output)
 - Main memory: 1 GB